

# Floor Plans

**GROUND FLOOR**  
FLOOR: G

ELARIS  
*Apex*

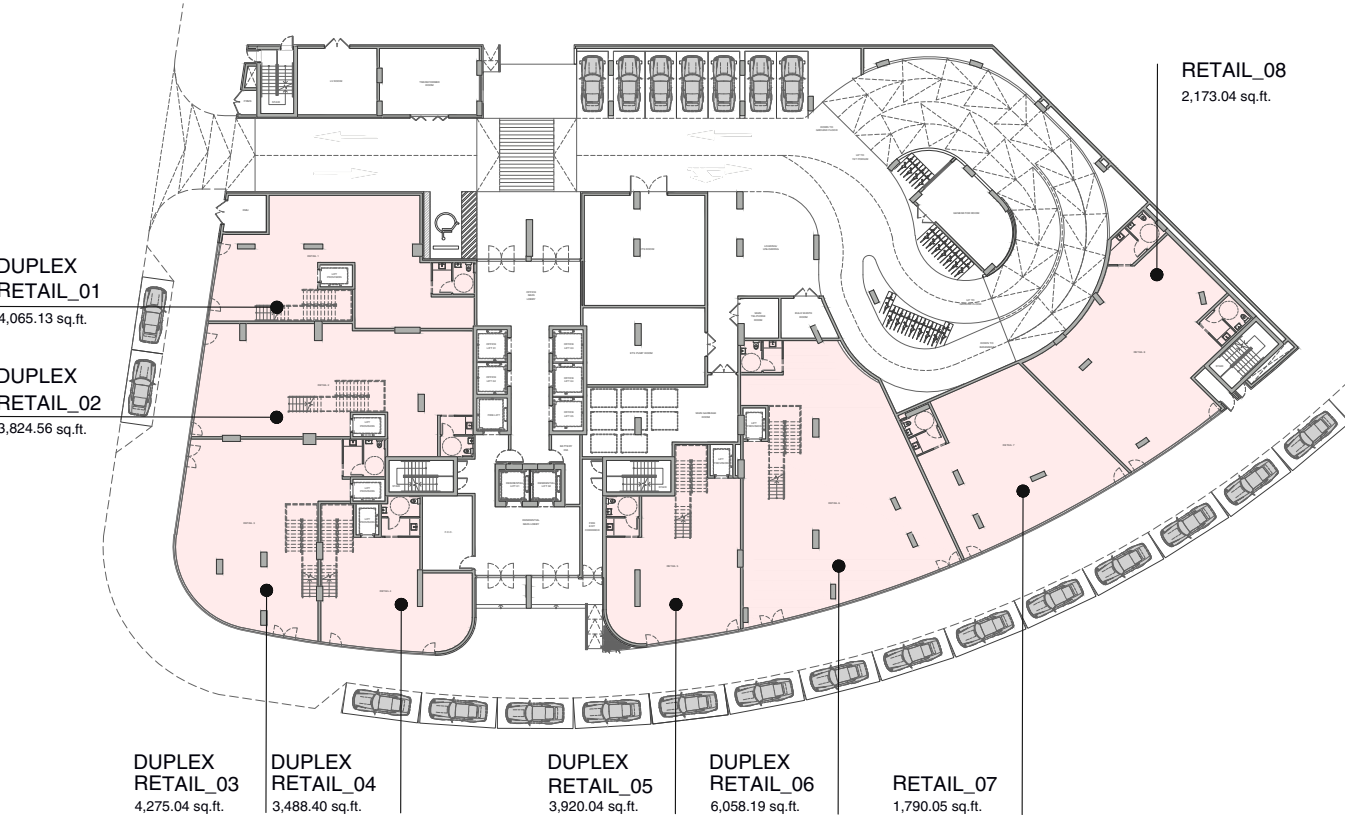

Disclaimer: all pictures, plans, layouts, information, data and details included in this brochure are indicative only may change at any time up to the final "as built" status in accordance with the final designs of the project, regulatory approvals and planning permissions

**TYPICAL FLOOR**  
FLOOR: PODIUM 1

ELARIS  
*Apex*

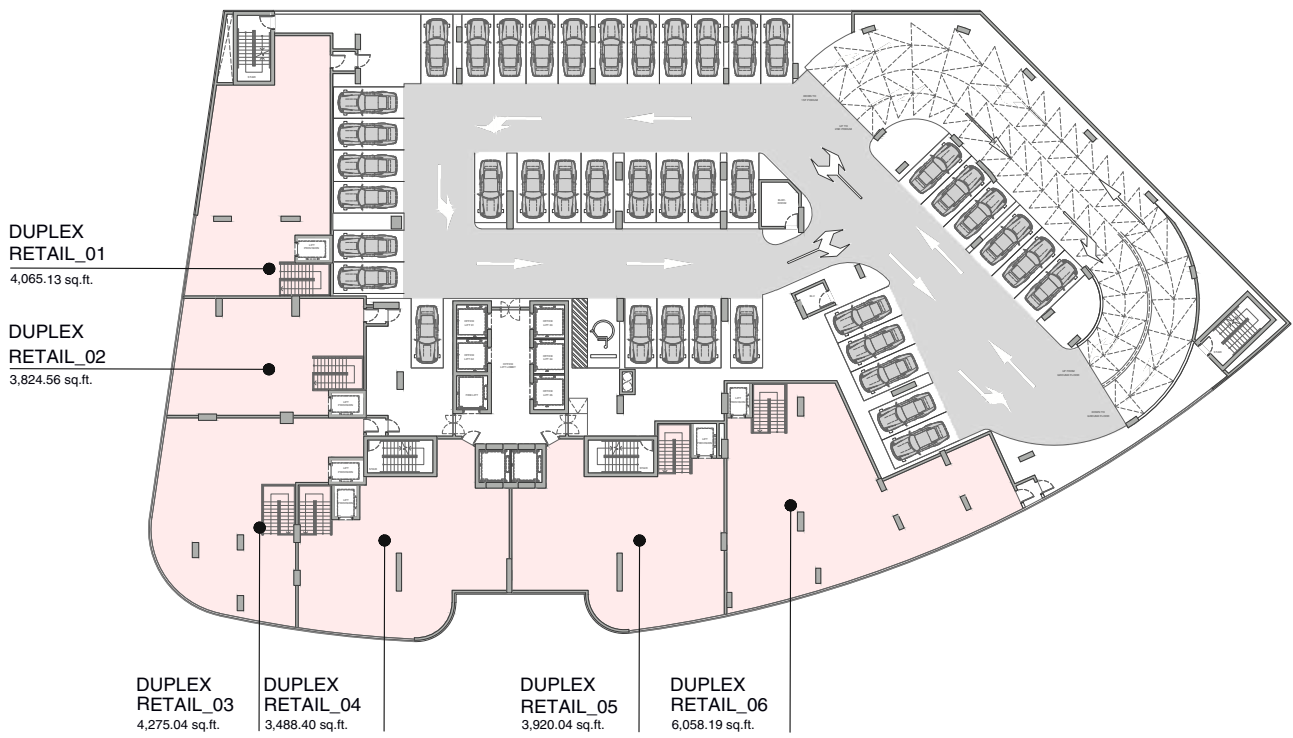

Disclaimer: all pictures, plans, layouts, information, data and details included in this brochure are indicative only may change at any time up to the final "as built" status in accordance with the final designs of the project, regulatory approvals and planning permissions

**TYPICAL FLOOR**  
FLOOR: 1

ELARIS  
*Apex*

DUBAI MARINA, JUMEIRAH ISLANDS

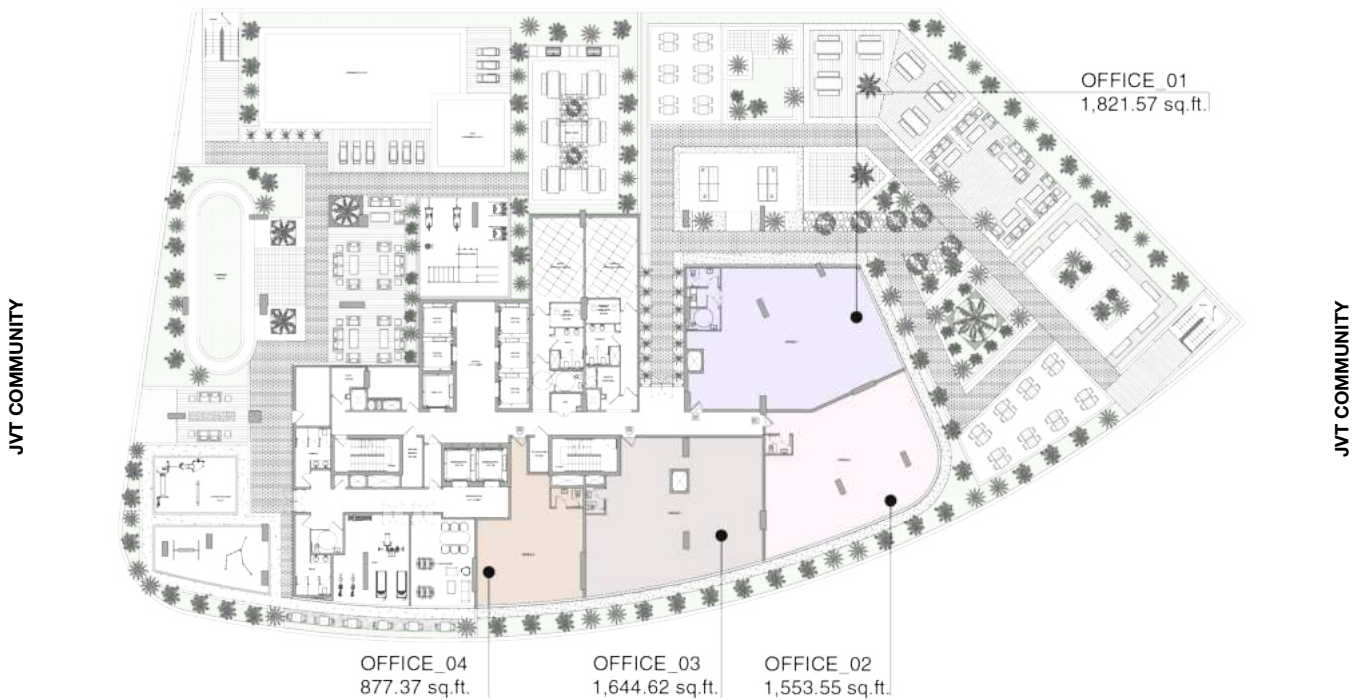

SHEIKH MOHAMMED BIN ZAYED RD (E 311)



**TYPICAL FLOOR**  
FLOOR: 2

ELARIS  
*Apex*

DUBAI MARINA, JUMEIRAH ISLANDS

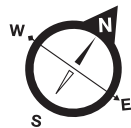
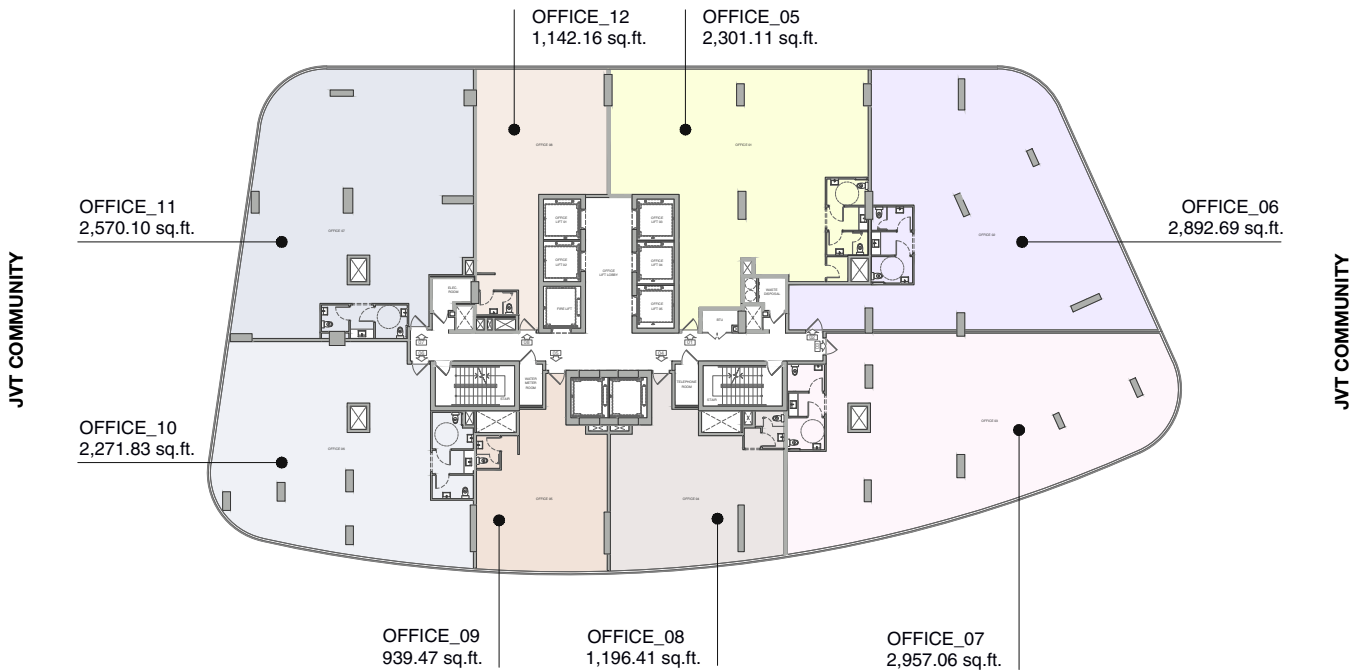

SHEIKH MOHAMMED BIN ZAYED RD (E 311)

Disclaimer: all pictures, plans, layouts, information, data and details included in this brochure are indicative only may change at any time up to the final "as built" status in accordance with the final designs of the project, regulatory approvals and planning permissions

**TYPICAL FLOOR**  
FLOOR: 3

ELARIS  
*Apex*

DUBAI MARINA, JUMEIRAH ISLANDS

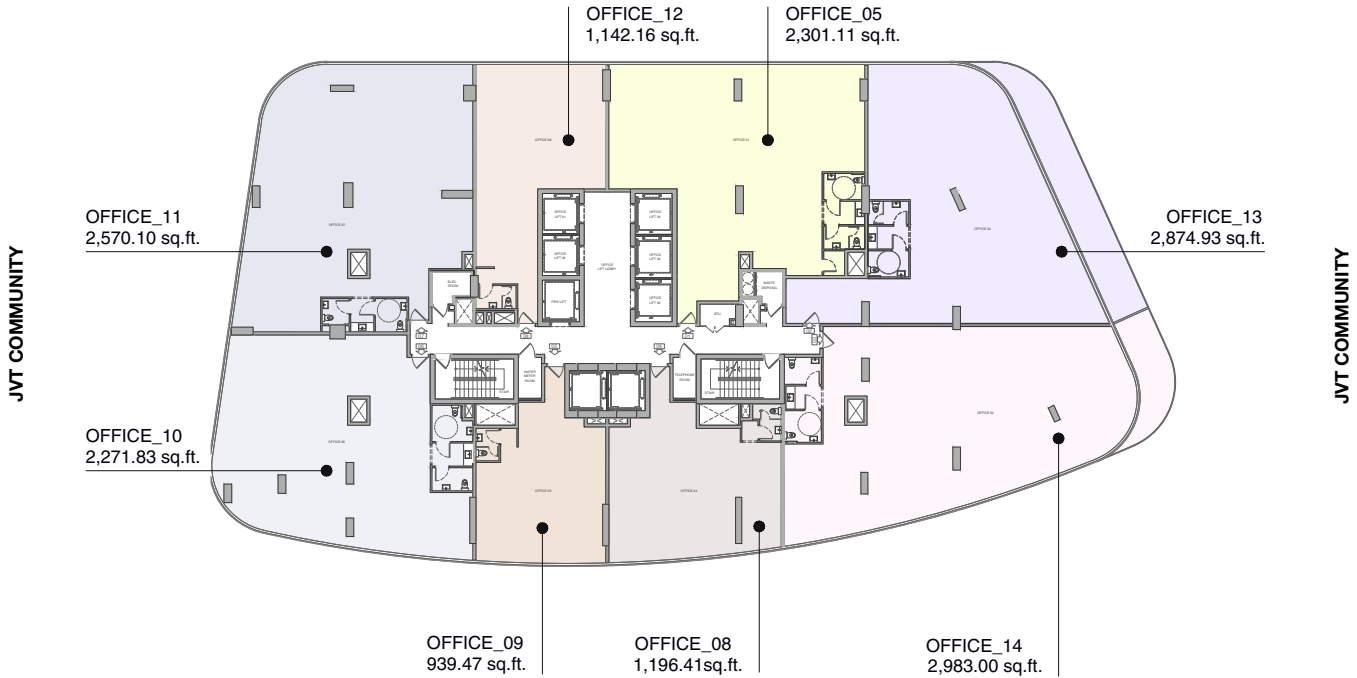

SHEIKH MOHAMMED BIN ZAYED RD (E 311)

Disclaimer: all pictures, plans, layouts, information, data and details included in this brochure are indicative only may change at any time up to the final "as built" status in accordance with the final designs of the project, regulatory approvals and planning permissions

**TYPICAL FLOOR**  
FLOOR: 4

ELARIS  
*April*

DUBAI MARINA, JUMEIRAH ISLANDS

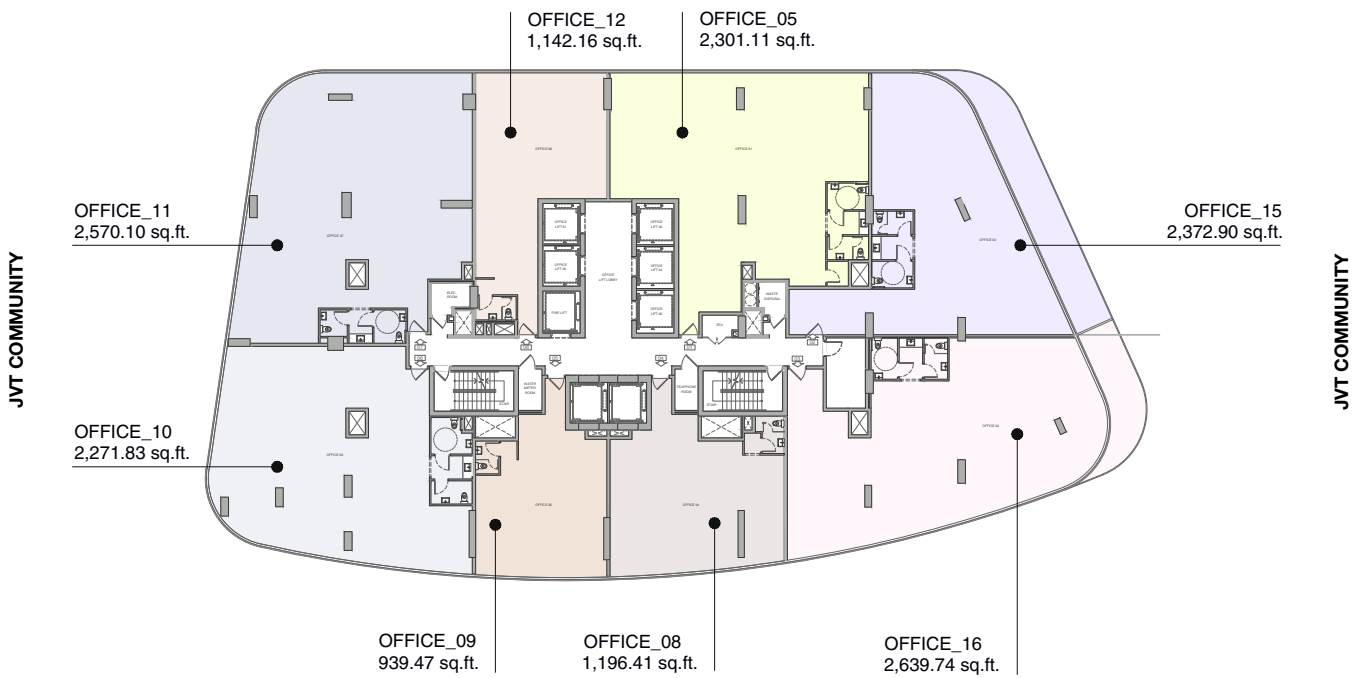

SHEIKH MOHAMMED BIN ZAYED RD (E 311)

Disclaimer: all pictures, plans, layouts, information, data and details included in this brochure are indicative only may change at any time up to the final "as built" status in accordance with the final designs of the project, regulatory approvals and planning permissions

**TYPICAL FLOOR**  
FLOOR: 5

ELARIS  
*Apex*

DUBAI MARINA, JUMEIRAH ISLANDS

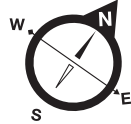
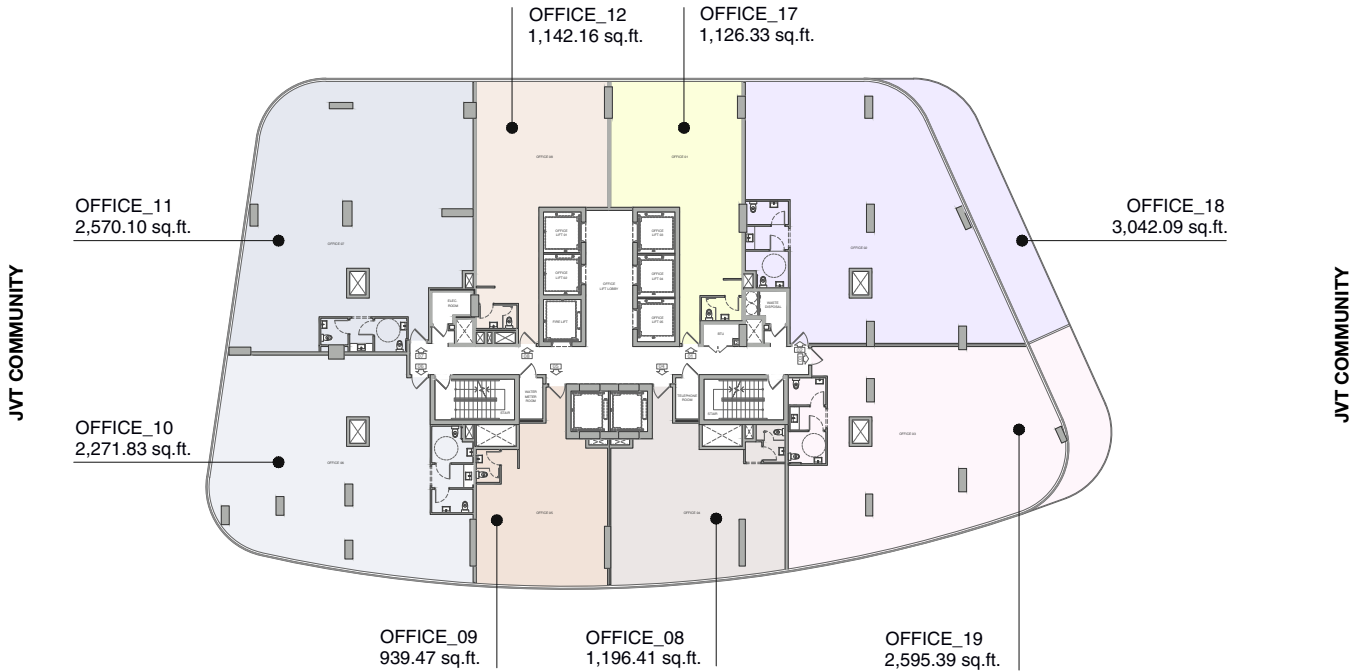

SHEIKH MOHAMMED BIN ZAYED RD (E 311)

Disclaimer: all pictures, plans, layouts, information, data and details included in this brochure are indicative only may change at any time up to the final "as built" status in accordance with the final designs of the project, regulatory approvals and planning permissions

**TYPICAL FLOOR**  
FLOOR: 6

ELARIS  
*Apex*

DUBAI MARINA, JUMEIRAH ISLANDS

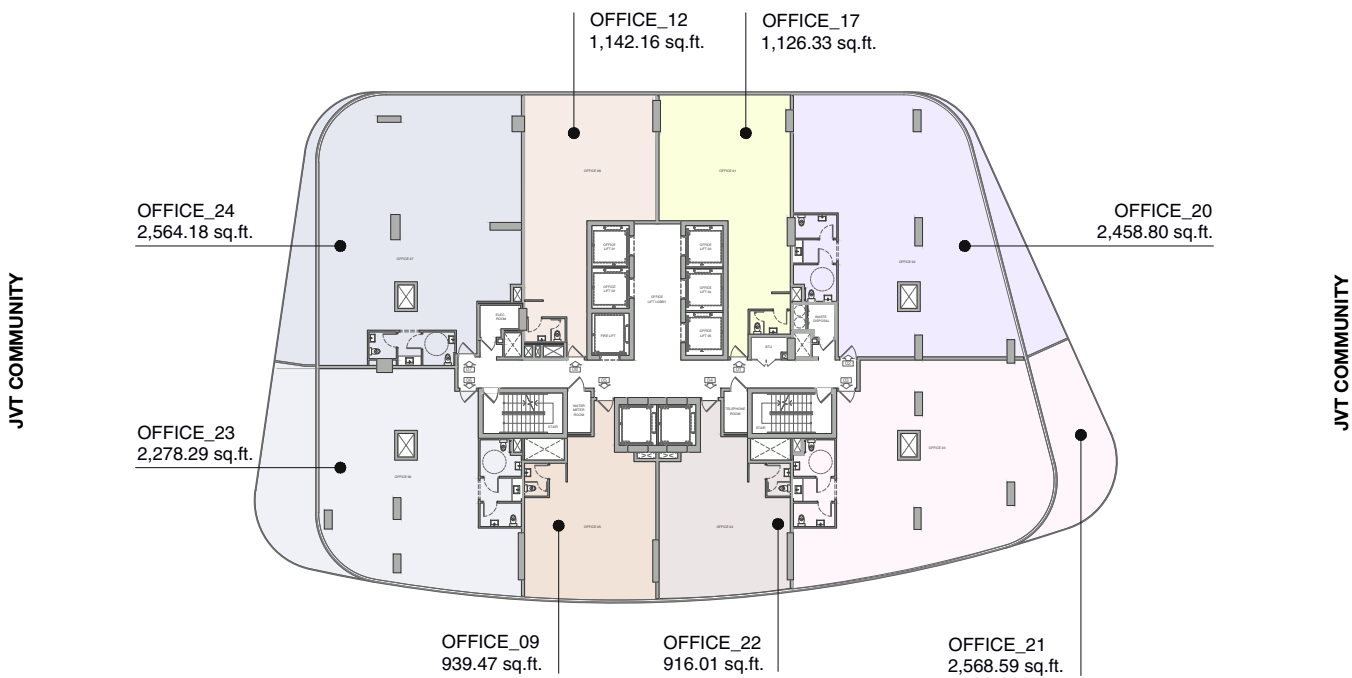

SHEIKH MOHAMMED BIN ZAYED RD (E 311)

Disclaimer: all pictures, plans, layouts, information, data and details included in this brochure are indicative only may change at any time up to the final "as built" status in accordance with the final designs of the project, regulatory approvals and planning permissions

**TYPICAL FLOOR**  
FLOOR: 7

ELARIS  
*Apex*

DUBAI MARINA, JUMEIRAH ISLANDS

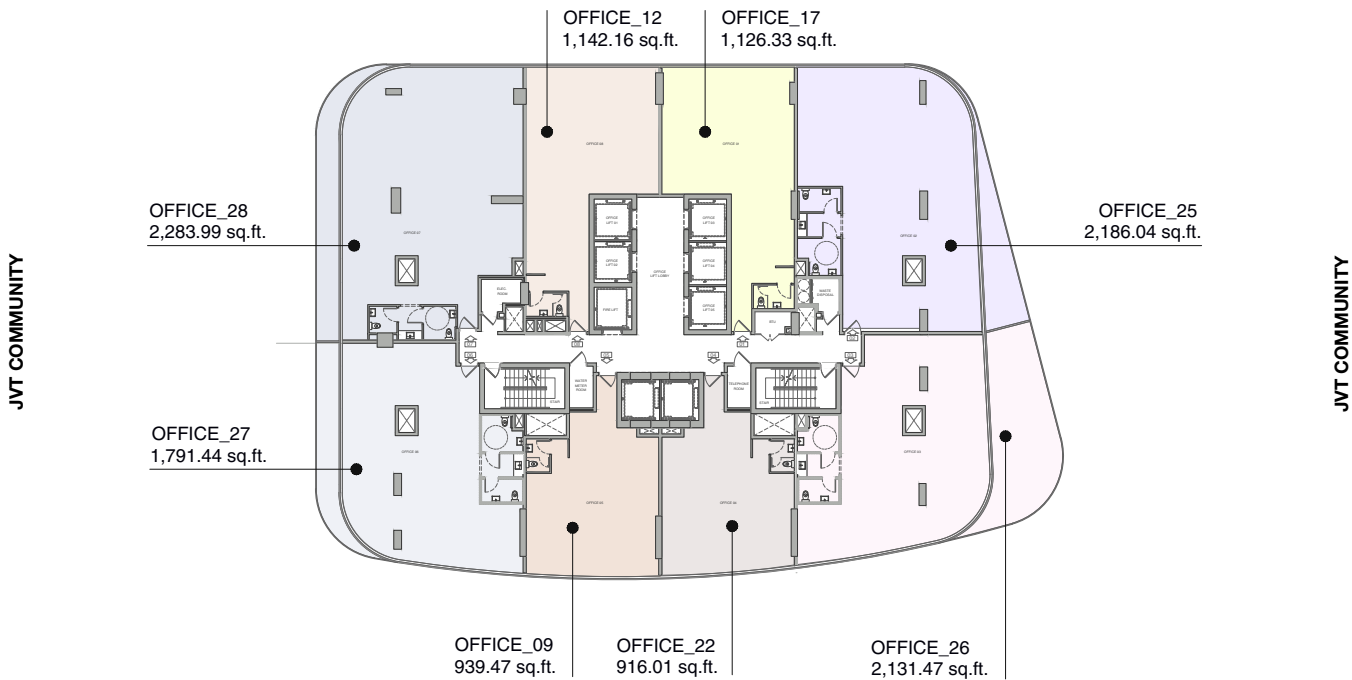

SHEIKH MOHAMMED BIN ZAYED RD (E 311)

Disclaimer: all pictures, plans, layouts, information, data and details included in this brochure are indicative only may change at any time up to the final "as built" status in accordance with the final designs of the project, regulatory approvals and planning permissions

**TYPICAL FLOOR**  
FLOOR: 8

ELARIS  
*Apex*

DUBAI MARINA, JUMEIRAH ISLANDS

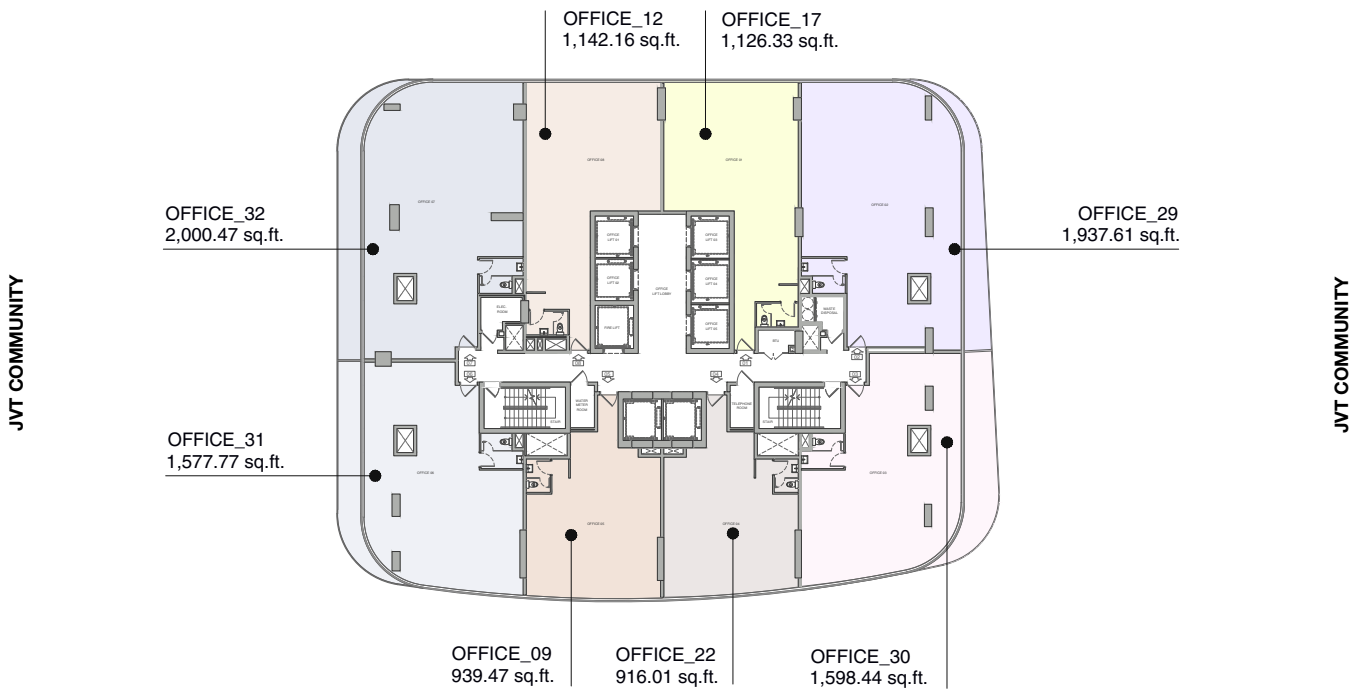

SHEIKH MOHAMMED BIN ZAYED RD (E 311)

Disclaimer: all pictures, plans, layouts, information, data and details included in this brochure are indicative only may change at any time up to the final "as built" status in accordance with the final designs of the project, regulatory approvals and planning permissions

**TYPICAL FLOOR**  
FLOOR: 9-11

ELARIS  
*Apex*

DUBAI MARINA, JUMEIRAH ISLANDS

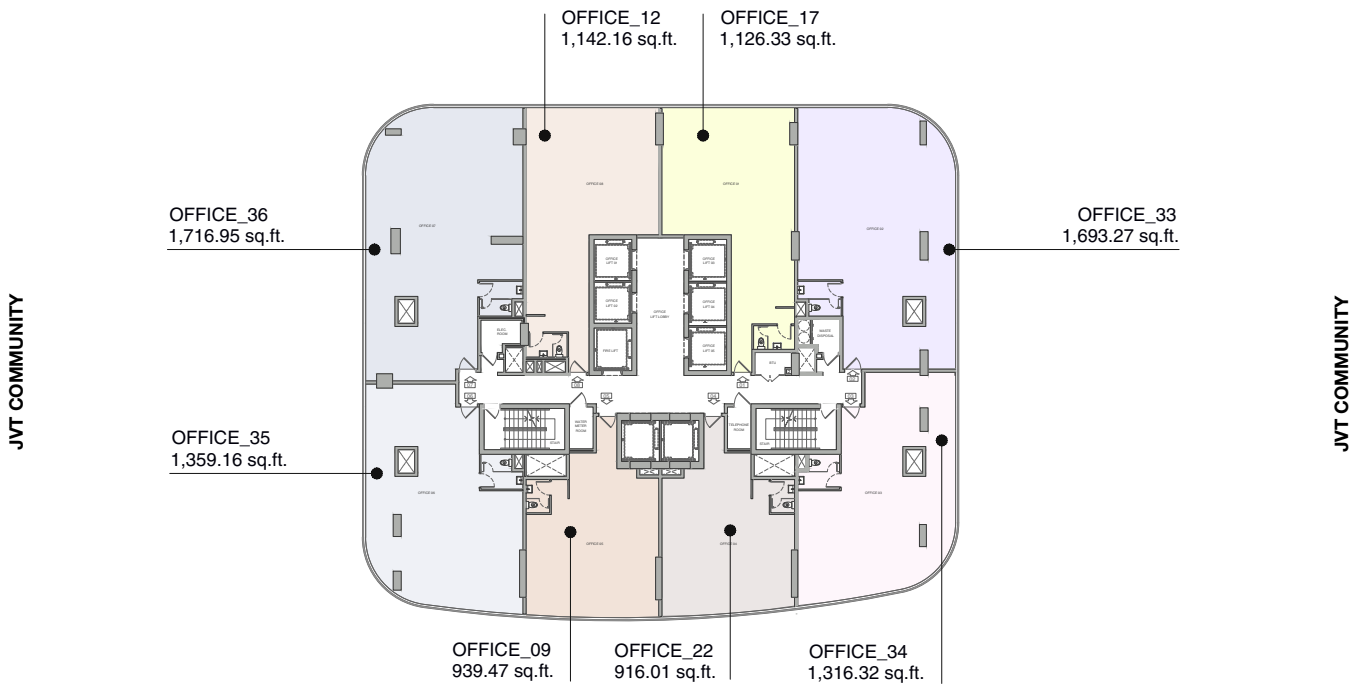

SHEIKH MOHAMMED BIN ZAYED RD (E 311)

Disclaimer: all pictures, plans, layouts, information, data and details included in this brochure are indicative only may change at any time up to the final "as built" status in accordance with the final designs of the project, regulatory approvals and planning permissions



**TYPICAL FLOOR**  
FLOOR: 12

ELARIS  
*Apex*

DUBAI MARINA, JUMEIRAH ISLANDS

JVT COMMUNITY

JVT COMMUNITY

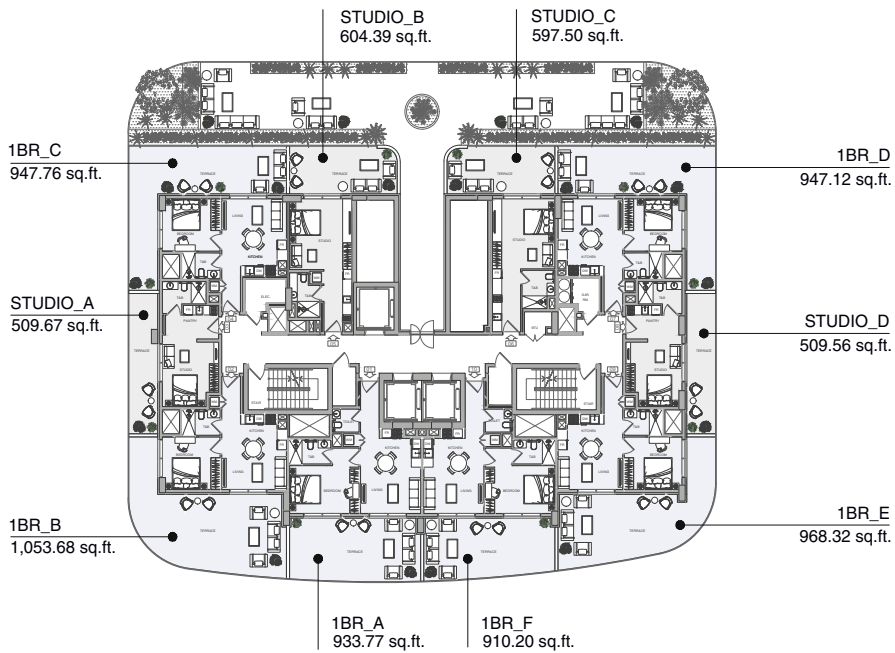

SHEIKH MOHAMMED BIN ZAYED RD (E 311)

Disclaimer: all pictures, plans, layouts, information, data and details included in this brochure are indicative only may change at any time up to the final "as built" status in accordance with the final designs of the project, regulatory approvals and planning permissions

**TYPICAL FLOOR**  
FLOOR: 13-18

ELARIS  
*Apex*

DUBAI MARINA, JUMEIRAH ISLANDS

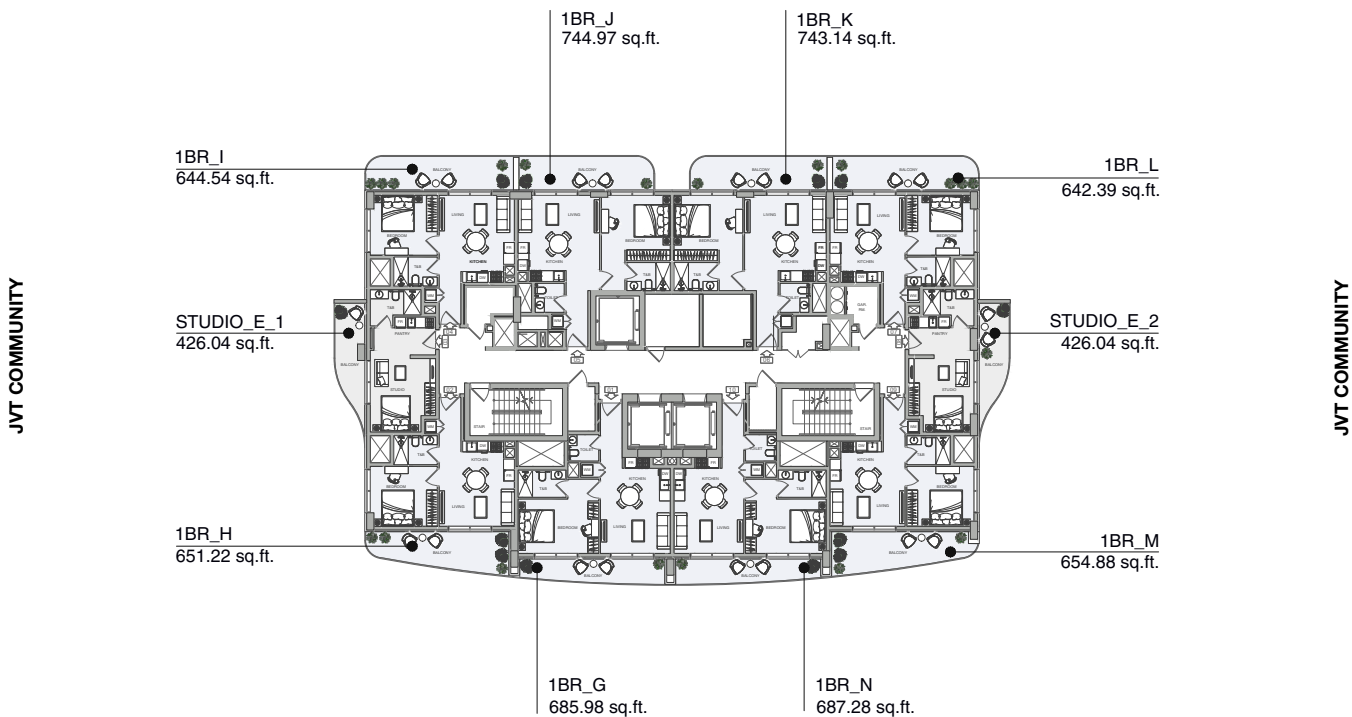

SHEIKH MOHAMMED BIN ZAYED RD (E 311)

ELARIS  
*Apus*

Studio

**STUDIO**

FLOOR: 12

ELARIS

*Apartment*

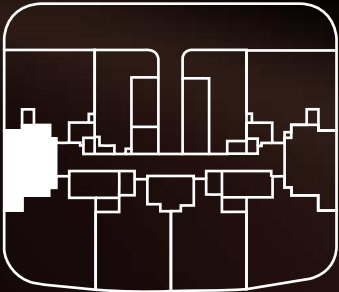

**STUDIO TYPE A**

SUITE AREA	<b>310.22</b>	sq. ft
BALCONY AREA	<b>199.46</b>	sq. ft
TOTAL SELLABLE AREA	<b>509.67</b>	sq. ft

Disclaimer: all pictures, plans, layouts, information, data and details included in this brochure are indicative only may change at any time up to the final "as built" status in accordance with the final designs of the project, regulatory approvals and planning permissions

**STUDIO**

FLOOR: 12

ELARIS  
*Apartment*

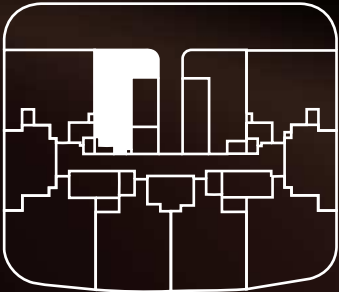

**STUDIO TYPE B**

SUITE AREA	<b>361.02</b>	sq. ft
BALCONY AREA	<b>243.37</b>	sq. ft
TOTAL SELLABLE AREA	<b>604.39</b>	sq. ft

Disclaimer: all pictures, plans, layouts, information, data and details included in this brochure are indicative only may change at any time up to the final "as built" status in accordance with the final designs of the project, regulatory approvals and planning permissions

**STUDIO**

FLOOR: 12

ELARIS  
*Apartment*

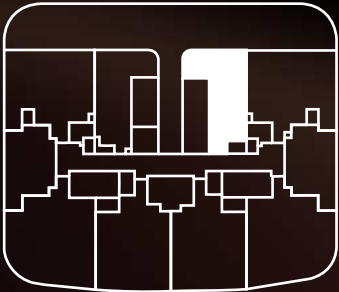

**STUDIO TYPE C**

SUITE AREA	<b>354.13</b>	sq. ft
BALCONY AREA	<b>243.37</b>	sq. ft
TOTAL SELLABLE AREA	<b>597.50</b>	sq. ft

Disclaimer: all pictures, plans, layouts, information, data and details included in this brochure are indicative only may change at any time up to the final "as built" status in accordance with the final designs of the project, regulatory approvals and planning permissions

**STUDIO**

FLOOR: 12

ELARIS  
*Apartment*

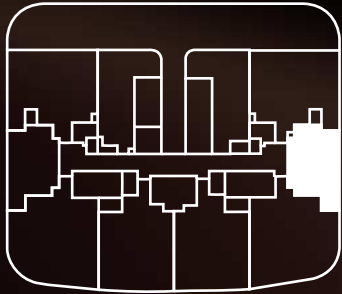

**STUDIO TYPE D**

SUITE AREA	<b>310.22</b>	sq. ft
BALCONY AREA	<b>199.35</b>	sq. ft
TOTAL SELLABLE AREA	<b>509.56</b>	sq. ft

Disclaimer: all pictures, plans, layouts, information, data and details included in this brochure are indicative only may change at any time up to the final "as built" status in accordance with the final designs of the project, regulatory approvals and planning permissions

**STUDIO**

FLOOR: 13-18

ELARIS  
*Apartment*

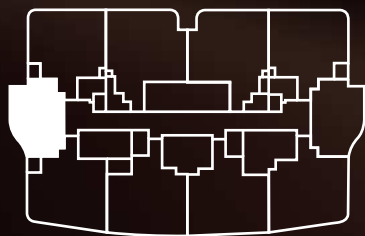

**STUDIO TYPE E\_1**

SUITE AREA	<b>310.22</b>	sq. ft
BALCONY AREA	<b>115.82</b>	sq. ft
TOTAL SELLABLE AREA	<b>426.04</b>	sq. ft

Disclaimer: all pictures, plans, layouts, information, data and details included in this brochure are indicative only may change at any time up to the final "as built" status in accordance with the final designs of the project, regulatory approvals and planning permissions



**STUDIO**

FLOOR: 13-18

ELARIS  
*Apartment*

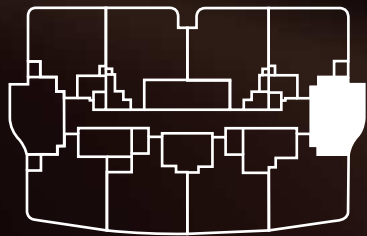

**STUDIO TYPE E\_2**

SUITE AREA	<b>310.22</b>	sq. ft
BALCONY AREA	<b>115.82</b>	sq. ft
TOTAL SELLABLE AREA	<b>426.04</b>	sq. ft

Disclaimer: all pictures, plans, layouts, information, data and details included in this brochure are indicative only may change at any time up to the final "as built" status in accordance with the final designs of the project, regulatory approvals and planning permissions

# One Bedroom

ONE BEDROOM

FLOOR: 12

ELARIS  
*Apartment*

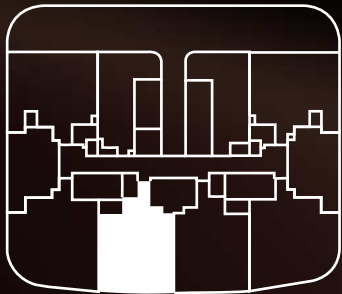

1 BR TYPE A

SUITE AREA	551.11	sq. ft
BALCONY AREA	382.66	sq. ft
TOTAL SELLABLE AREA	933.77	sq. ft

Disclaimer: all pictures, plans, layouts, information, data and details included in this brochure are indicative only may change at any time up to the final "as built" status in accordance with the final designs of the project, regulatory approvals and planning permissions

ONE BEDROOM

FLOOR: 12

ELARIS  
*Apartment*

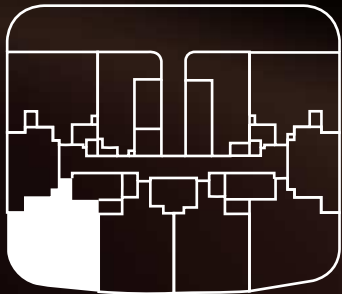

1 BR TYPE B

SUITE AREA	56.12	sq. ft
BALCONY AREA	591.69	sq. ft
TOTAL SELLABLE AREA	1,053.68	sq. ft

Disclaimer: all pictures, plans, layouts, information, data and details included in this brochure are indicative only may change at any time up to the final "as built" status in accordance with the final designs of the project, regulatory approvals and planning permissions

ONE BEDROOM

FLOOR: 12

ELARIS  
*Apartment*

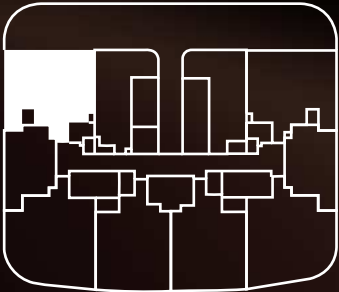

1 BR TYPE C

SUITE AREA	463.17	sq. ft
BALCONY AREA	484.59	sq. ft
TOTAL SELLABLE AREA	947.76	sq. ft

Disclaimer: all pictures, plans, layouts, information, data and details included in this brochure are indicative only may change at any time up to the final "as built" status in accordance with the final designs of the project, regulatory approvals and planning permissions

ONE BEDROOM

FLOOR: 12

ELARIS  
*Apartment*

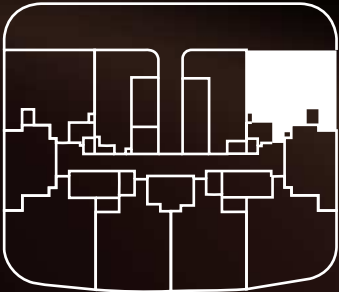

1 BR TYPE D

SUITE AREA	462.52	sq. ft
BALCONY AREA	484.59	sq. ft
TOTAL SELLABLE AREA	947.12	sq. ft

Disclaimer: all pictures, plans, layouts, information, data and details included in this brochure are indicative only may change at any time up to the final "as built" status in accordance with the final designs of the project, regulatory approvals and planning permissions

ONE BEDROOM

FLOOR: 12

ELARIS  
*Apartment*

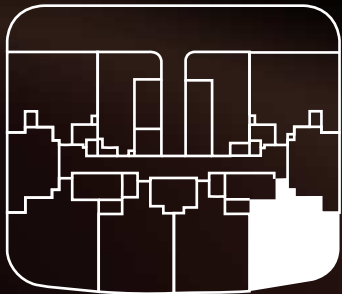

1 BR TYPE E

SUITE AREA	461.99	sq. ft
BALCONY AREA	506.33	sq. ft
TOTAL SELLABLE AREA	968.32	sq. ft

Disclaimer: all pictures, plans, layouts, information, data and details included in this brochure are indicative only may change at any time up to the final "as built" status in accordance with the final designs of the project, regulatory approvals and planning permissions

ONE BEDROOM

FLOOR: 12

ELARIS  
*Apartment*

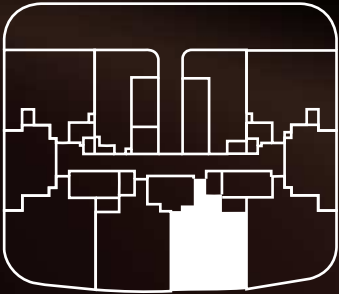

1 BR TYPE F

SUITE AREA	551.11	sq. ft
BALCONY AREA	359.08	sq. ft
TOTAL SELLABLE AREA	910.20	sq. ft

Disclaimer: all pictures, plans, layouts, information, data and details included in this brochure are indicative only may change at any time up to the final "as built" status in accordance with the final designs of the project, regulatory approvals and planning permissions



# ONE BEDROOM

FLOOR: 13-18

ELARIS  
*Apartment*

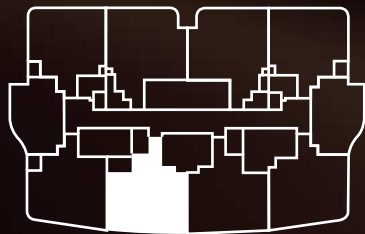

## 1 BR TYPE G

SUITE AREA	<b>551.11</b>	sq. ft
BALCONY AREA	<b>134.87</b>	sq. ft
TOTAL SELLABLE AREA	<b>685.98</b>	sq. ft

Disclaimer: all pictures, plans, layouts, information, data and details included in this brochure are indicative only may change at any time up to the final "as built" status in accordance with the final designs of the project, regulatory approvals and planning permissions

ONE BEDROOM

FLOOR: 13-18

ELARIS  
*Apartment*

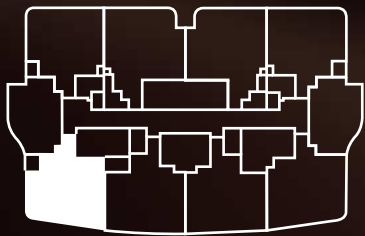

1 BR TYPE H

SUITE AREA	460.91	sq. ft
BALCONY AREA	190.31	sq. ft
TOTAL SELLABLE AREA	651.22	sq. ft

ONE BEDROOM

FLOOR: 13-18

ELARIS  
*Apartment*

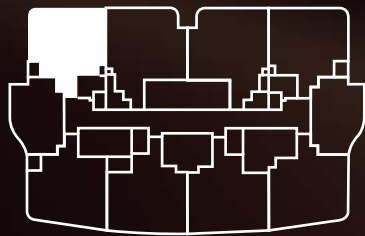

1 BR TYPE I

SUITE AREA	462.52	sq. ft
BALCONY AREA	182.02	sq. ft
TOTAL SELLABLE AREA	644.54	sq. ft

Disclaimer: all pictures, plans, layouts, information, data and details included in this brochure are indicative only may change at any time up to the final "as built" status in accordance with the final designs of the project, regulatory approvals and planning permissions

ONE BEDROOM

FLOOR: 13-18

ELARIS  
*Apartment*

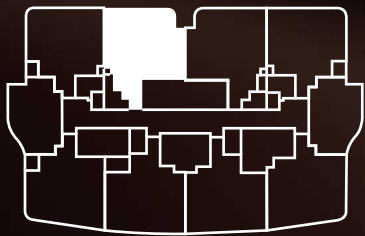

1 BR TYPE J

SUITE AREA	580.07	sq. ft
BALCONY AREA	164.90	sq. ft
TOTAL SELLABLE AREA	744.97	sq. ft

ONE BEDROOM

FLOOR: 13-18

ELARIS

*Apartment*

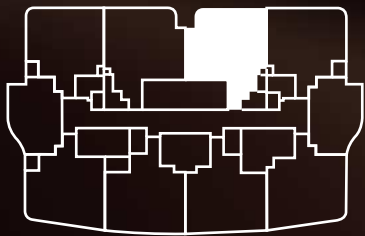

1 BR TYPE K

SUITE AREA	575.98	sq. ft
BALCONY AREA	167.16	sq. ft
TOTAL SELLABLE AREA	743.14	sq. ft

ONE BEDROOM

FLOOR: 13-18

ELARIS  
*Apartment*

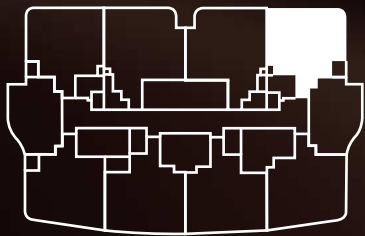

1 BR TYPE L

SUITE AREA	462.52	sq. ft
BALCONY AREA	179.86	sq. ft
TOTAL SELLABLE AREA	642.39	sq. ft

Disclaimer: all pictures, plans, layouts, information, data and details included in this brochure are indicative only may change at any time up to the final "as built" status in accordance with the final designs of the project, regulatory approvals and planning permissions

ONE BEDROOM

FLOOR: 13-18

ELARIS  
*Apartment*

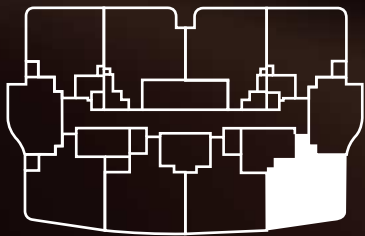

1 BR TYPE M

SUITE AREA	461.99	sq. ft
BALCONY AREA	192.89	sq. ft
TOTAL SELLABLE AREA	654.88	sq. ft

Disclaimer: all pictures, plans, layouts, information, data and details included in this brochure are indicative only may change at any time up to the final "as built" status in accordance with the final designs of the project, regulatory approvals and planning permissions

ONE BEDROOM

FLOOR: 13-18

ELARIS  
*Apartment*

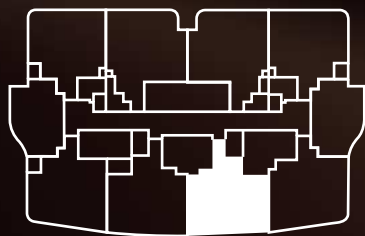

1 BR TYPE N

SUITE AREA	551.54	sq. ft
BALCONY AREA	135.73	sq. ft
TOTAL SELLABLE AREA	687.28	sq. ft

Disclaimer: all pictures, plans, layouts, information, data and details included in this brochure are indicative only may change at any time up to the final "as built" status in accordance with the final designs of the project, regulatory approvals and planning permissions