

Typical Floor Plan

Buidling Structure



Typical Floor Plan

LEVEL - 1 AMENITIES

- 1. Adult Pool
- 2. Kids Pool
- 3. Gym
- 4. Changing Rooms
- 5. Multipurpose Room
- 6. Indoor Lounge
- 7. Lobby & Drop-Off

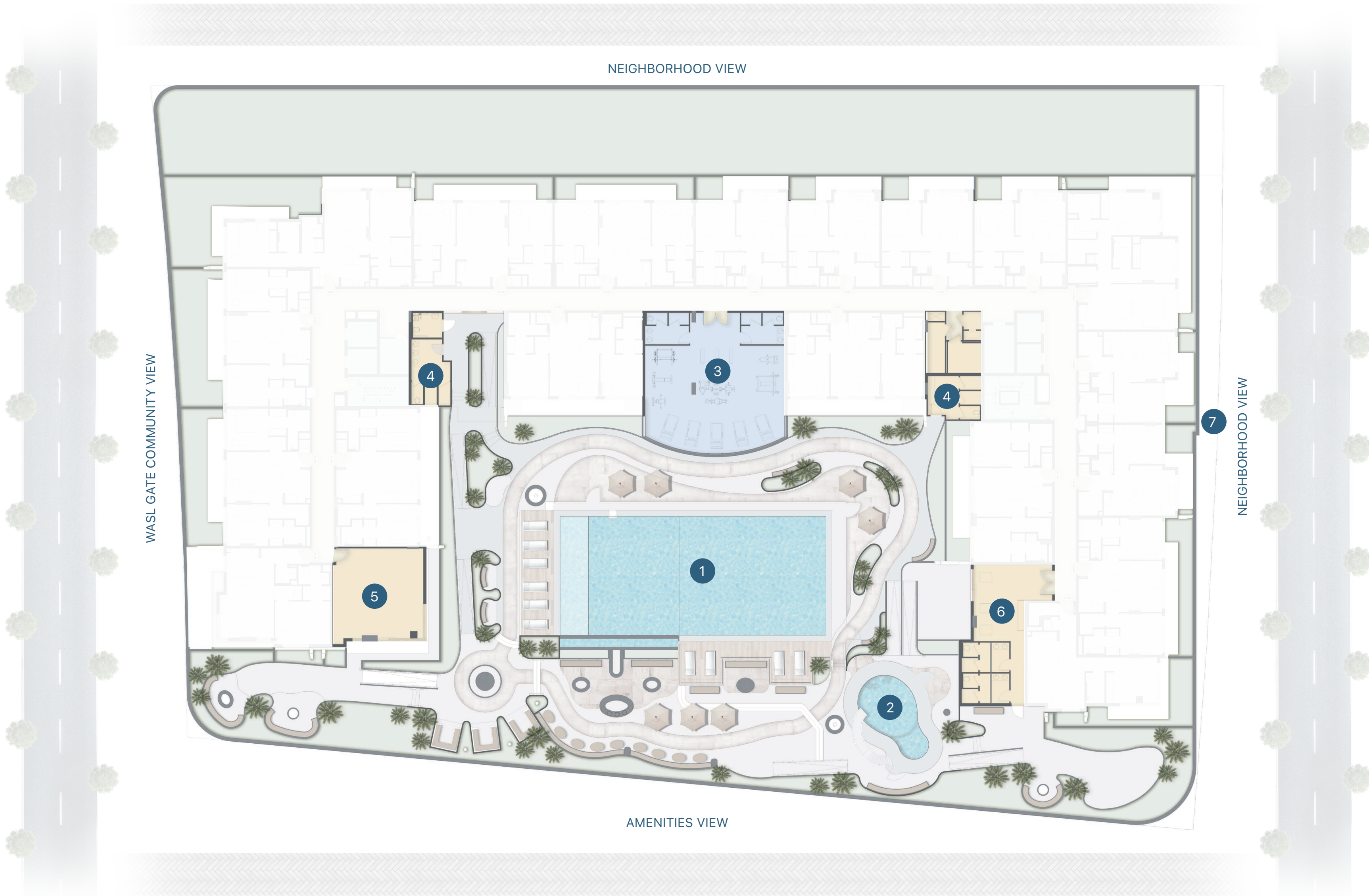

Typical Floor Plan

LEVEL - 1
RESIDENTIAL

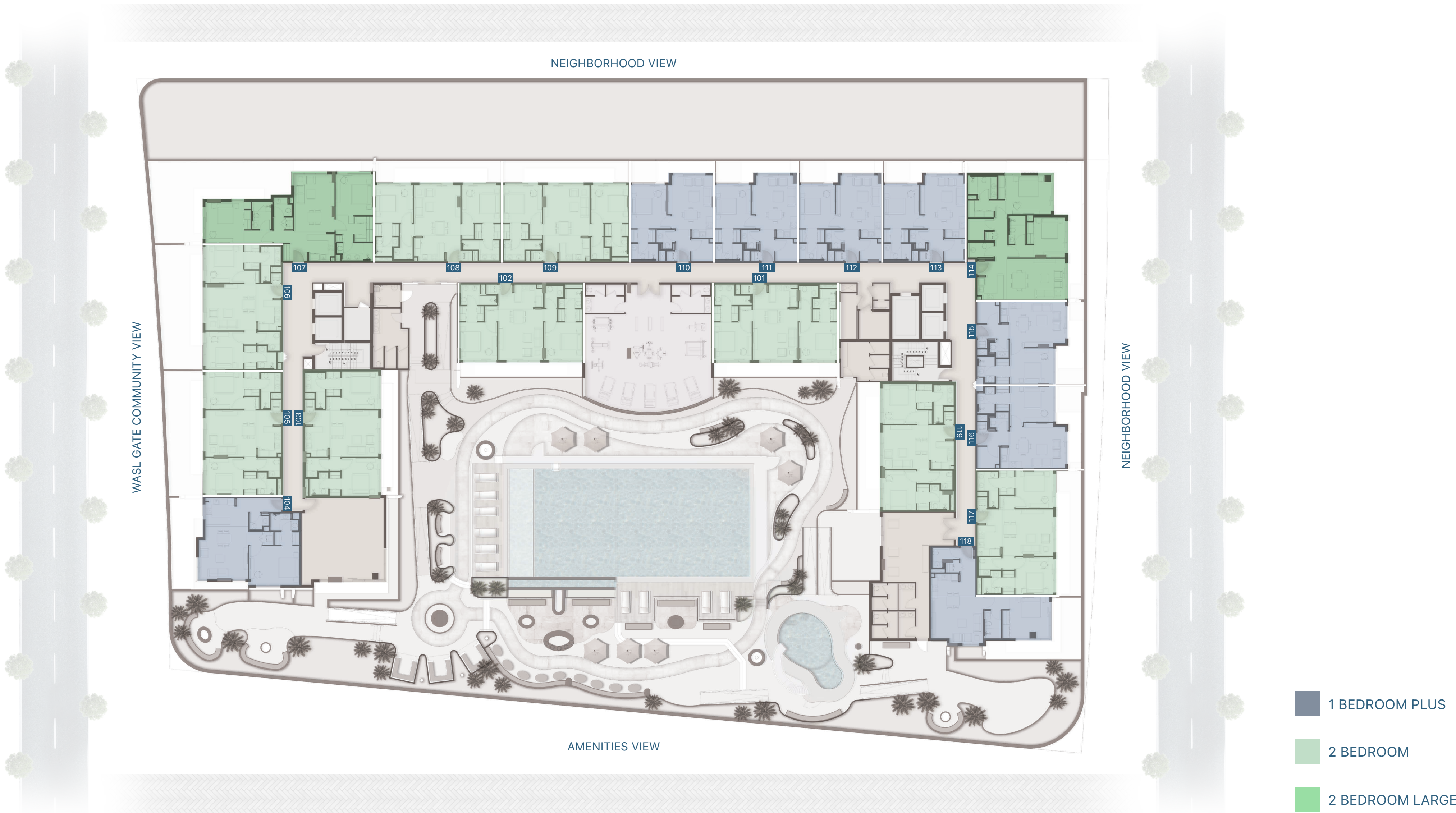

All images used are for illustrative purposes only and do not represent the actual size, features, specifications, fittings and furnishings. The developer reserves the right to make revisions / alterations, at its absolute discretion, without any liability whatsoever.

Typical Floor Plan

LEVEL - 2 RESIDENTIAL

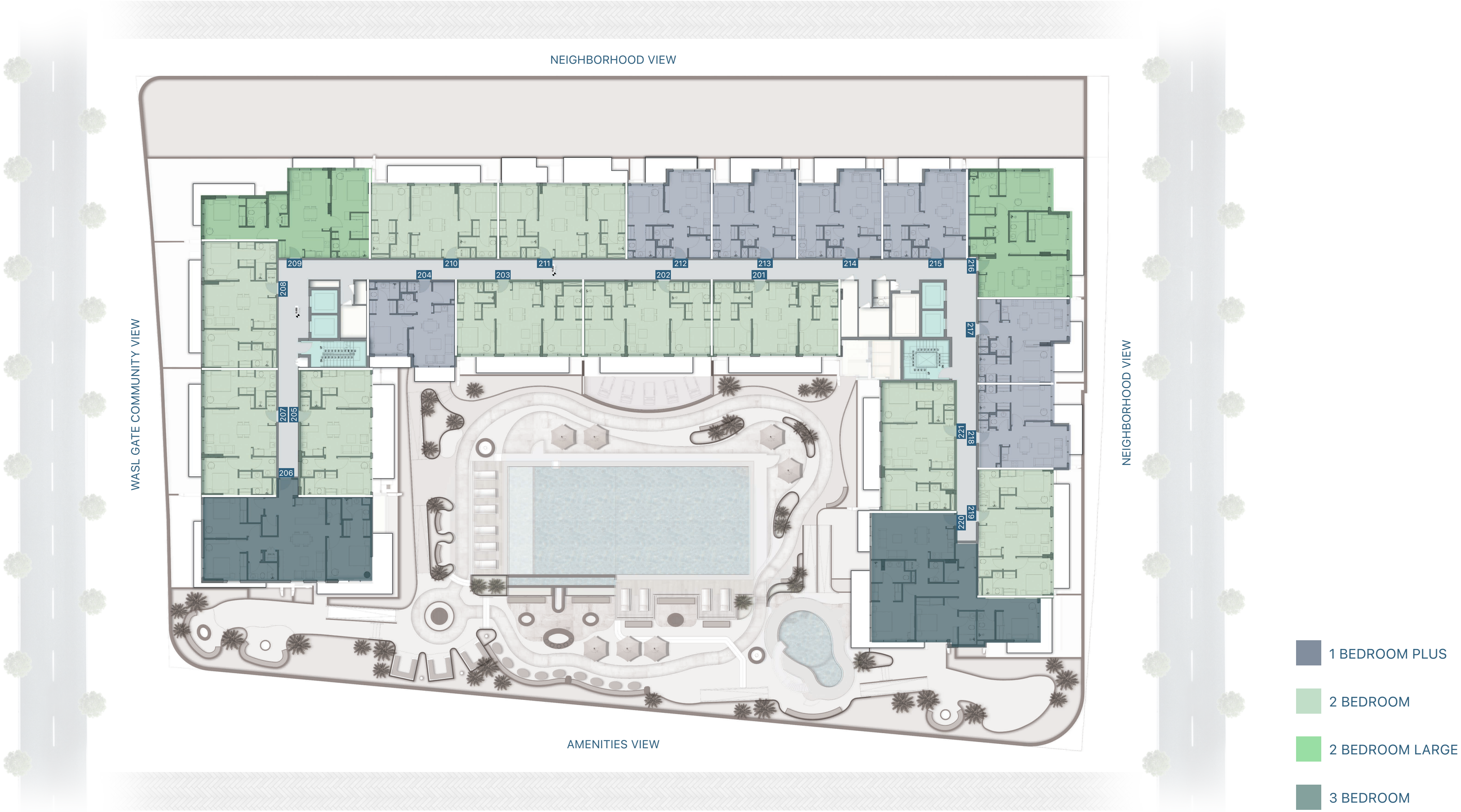

All images used are for illustrative purposes only and do not represent the actual size, features, specifications, fittings and furnishings. The developer reserves the right to make revisions / alterations, at its absolute discretion, without any liability whatsoever.

Typical Floor Plan

LEVEL - 3 to 12
RESIDENTIAL

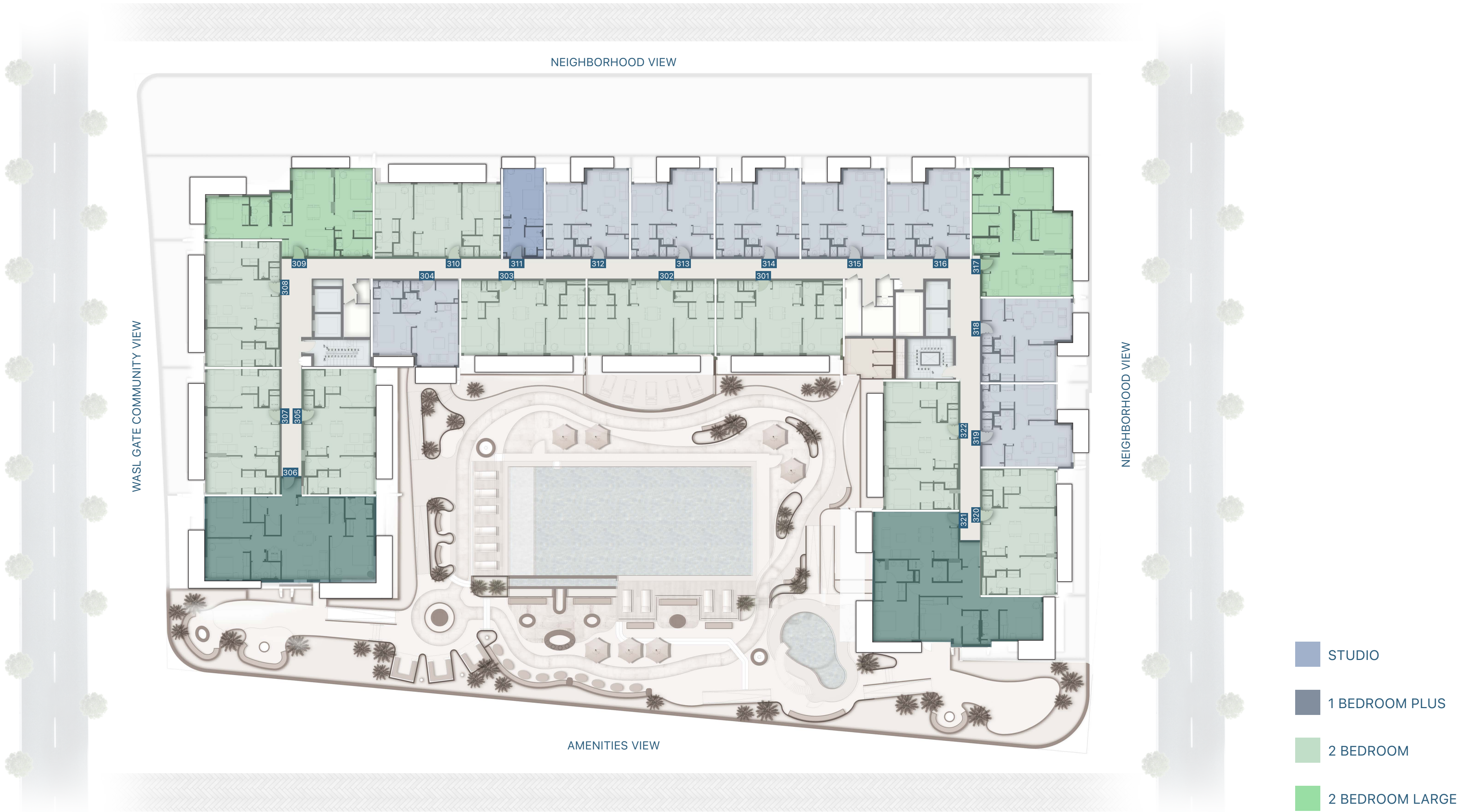

All images used are for illustrative purposes only and do not represent the actual size, features, specifications, fittings and furnishings. The developer reserves the right to make revisions / alterations, at its absolute discretion, without any liability whatsoever.

Unit Plans

Unit Floor Plan

STUDIO

SUITE AREA	362 SQ.FT
BALCONY AREA	30 SQ.FT
TOTAL AREA	392 SQ.FT

1. KITCHEN	2.6M X 1.95M
2. LIVING & BED	4.75M X 3.8M
3. BATHROOM	2.7M X 1.175M
4. LAUNDRY	0.8M X 0.8M

Balconies and entrance varies depending on the floor

All images used are for illustrative purposes only and do not represent the actual size, features, specifications, fittings and furnishings. The developer reserves the right to make revisions / alterations, at its absolute discretion, without any liability whatsoever.

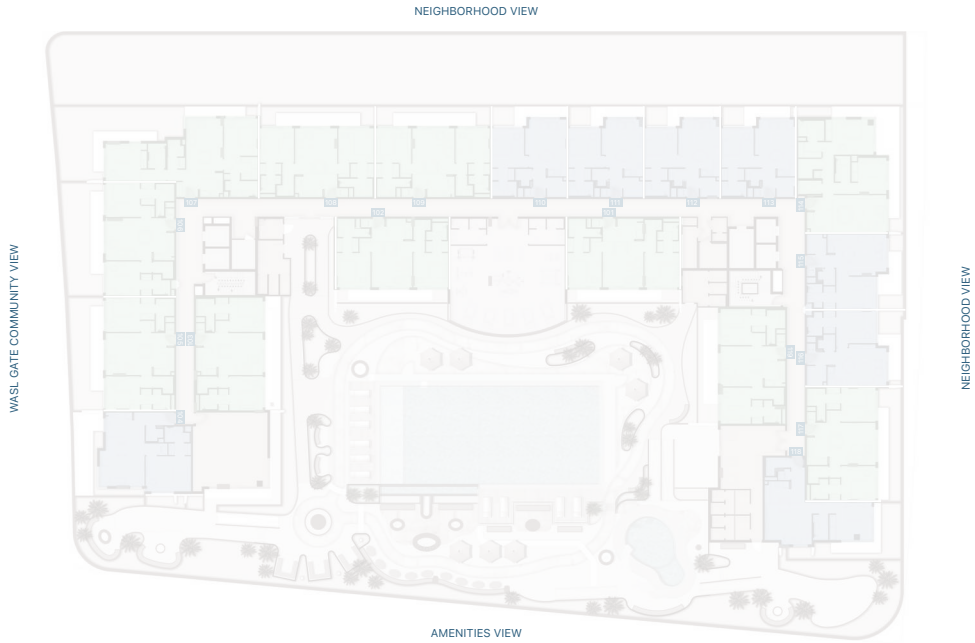

LEVEL 1

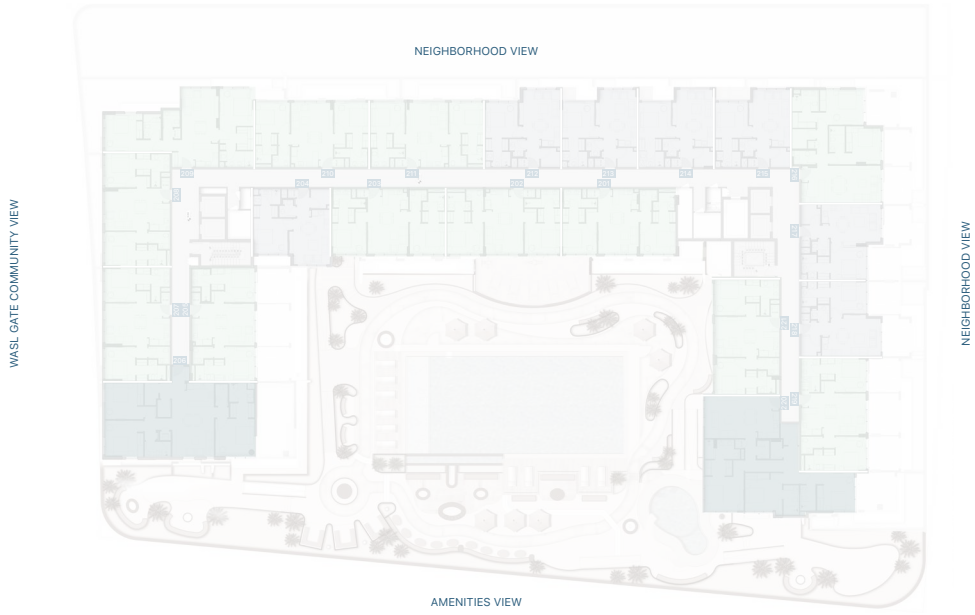

LEVEL 2

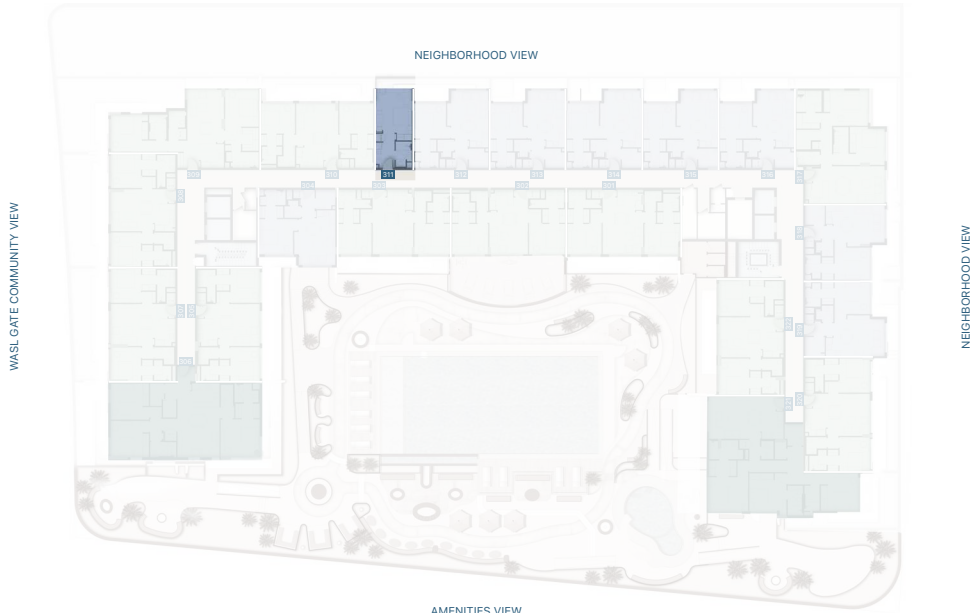

LEVEL 3 - 12

Unit Floor Plan

1 BEDROOM PLUS

SUITE AREA	637 - 753 SQ.FT
BALCONY AREA	73 - 358 SQ.FT
TOTAL AREA	707 - 1,073 SQ.FT
1. ENTRANCE	1.3M X 2.9M
2. KITCHEN	1.9M X 2.0M
3. LIVING & DINING	4.2M X 4.0M
4. POWDER ROOM	1.7M X 1.9M
5. MASTER BEDROOM	3.3M X 4.0M
6. WALK IN CLOSET	2.3M X 1.2M
7. MASTER BATHROOM	2.55M X 1.6M
8. LAUNDRY	0.8M X 0.9M
9. STORAGE	2.0M X 2.0M

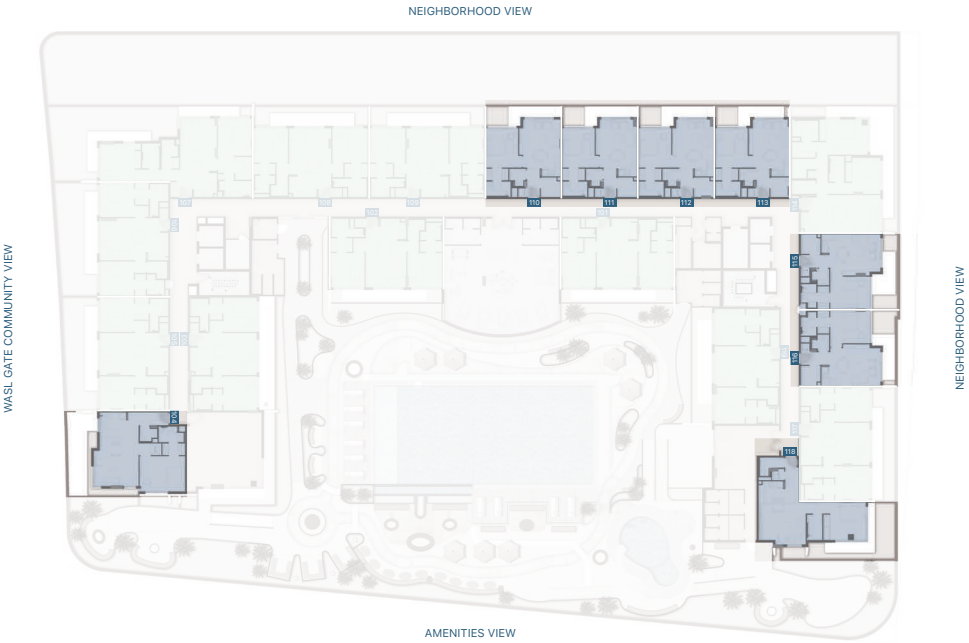

LEVEL 1

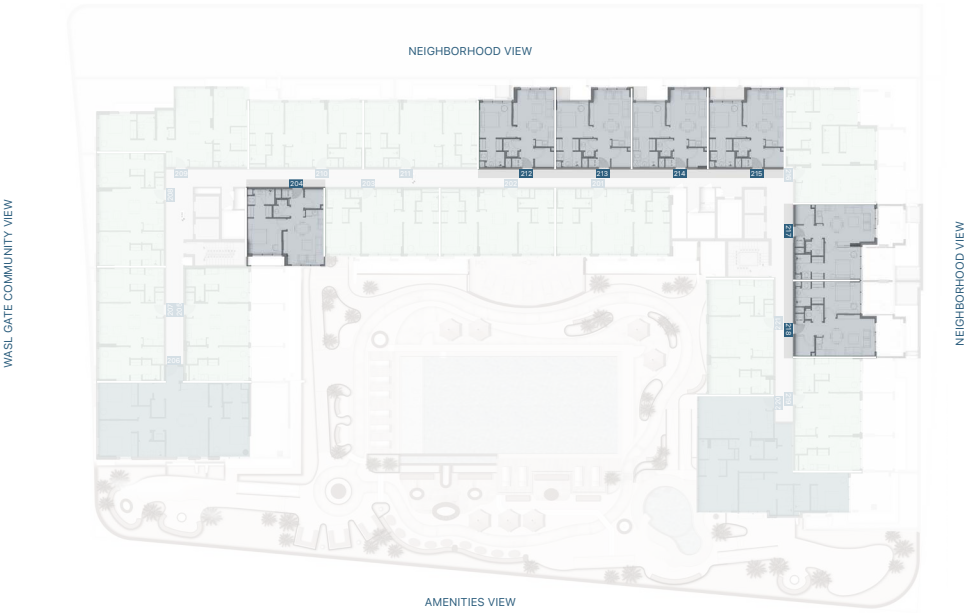

LEVEL 2

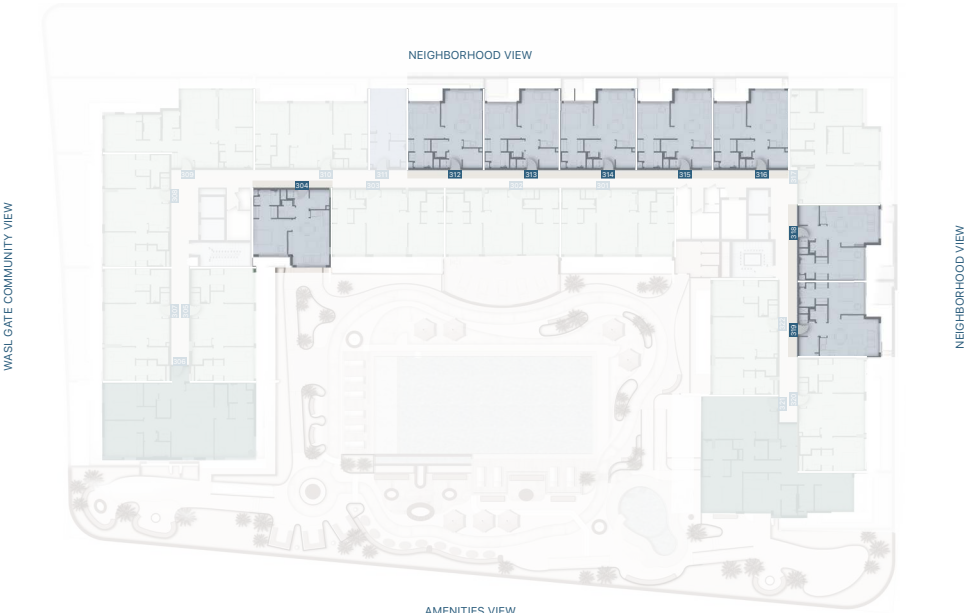

LEVEL 3 - 12

Balconies and entrance varies depending on the floor

All images used are for illustrative purposes only and do not represent the actual size, features, specifications, fittings and furnishings. The developer reserves the right to make revisions / alterations, at its absolute discretion, without any liability whatsoever.

Unit Floor Plan

2 BEDROOM

SUITE AREA	854 - 1,054 SQ.FT
BALCONY AREA	113 - 840 SQ.FT
TOTAL AREA	977 - 1,871 SQ.FT

1. ENTRANCE	2.3M X 1.3M
2. KITCHEN	2.1M X 2.8M
3. LIVING & DINING	4.6M X 4.3M
4. POWDER ROOM	2.2M X 1.8M
5. BEDROOM 1	3.5M X 3.5M
6. WALK IN CLOSET	1.1M X 2.2M
7. BATHROOM	1.8M X 2.2M
8. BEDROOM 2	3.5M X 3.6M
9. WALK IN CLOSET	1.4M X 2.2M
10. BATHROOM	1.9M X 2.0M
11. LAUNDRY	0.6M X 0.7M

Balconies and entrance varies depending on the floor

All images used are for illustrative purposes only and do not represent the actual size, features, specifications, fittings and furnishings. The developer reserves the right to make revisions / alterations, at its absolute discretion, without any liability whatsoever.



LEVEL 1



LEVEL 2

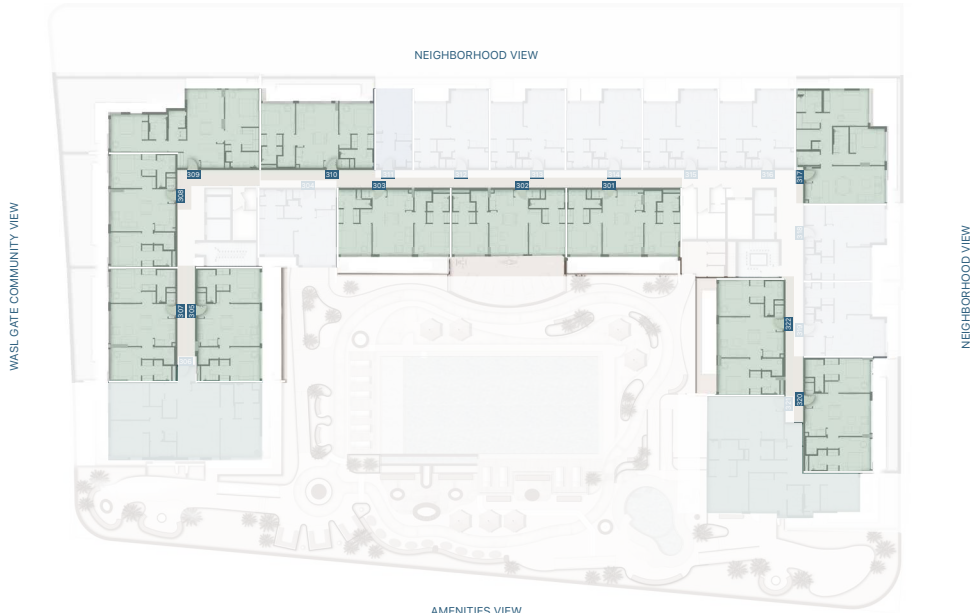

LEVEL 3 - 12



Unit Floor Plan

3 BEDROOM PLUS

SUITE AREA	1,355 - 1,443 SQ.FT
BALCONY AREA	276 - 420 SQ.FT
TOTAL AREA	1,631 - 1,863 SQ.FT
1. KITCHEN	2.8M X 2.2M
2. LIVING & DINING	4.3M X 5.2M
3. POWDER ROOM	2.0M X 1.3M
4. MASTER BEDROOM	3.47M X 4.0M
5. WALK IN CLOSET	1.6M X 2.8M
6. MASTER BATHROOM	2.0M X 3.6M
7. BEDROOM 1	3.8M X 3.8M
8. BATHROOM	3.0M X 1.6M
9. BEDROOM 2	3.8M X 3.8M
10. BATHROOM	2.6M X 1.6
11. LAUNDRY 1	0.9M X 0.9M
12. BATHROOM	2.0M X 1.2M
13. STORAGE	2.2M X 1.9M

Balconies and entrance varies depending on the floor

All images used are for illustrative purposes only and do not represent the actual size, features, specifications, fittings and furnishings.The developer reserves the right to make revisions / alterations, at its absolute discretion, without any liability whatsoever.

